

Premises Licence

Premises Licence Number

20/02035/LIPREM

Part 1 – Premises Details

Postal address of premises, or if none, ordnance survey map reference or description, including Post Town, Post Code

Aycorn - The Shoppe
6 The Parade
258 Coulsdon Road
Coulsdon
CR5 1EH

Telephone number:

N/k

Where the licence is time limited the dates

N/A

Licensable activities authorised by the licence

Recorded Music
Sale by retail of alcohol

Times the licence authorises the carrying out of licensable activities

Recorded Music
Monday to Saturday 08:00 - 21:00 hours

Sale by retail of alcohol
Monday to Saturday 12:00 - 21:00 hours

The opening hours of the premises

Monday to Saturday 08:00 - 21:00 hours

Where the licence authorises supplies of alcohol whether these are on and/or off supplies

On & Off

Part 2**Name, (registered) address of holder of premises licence**

Aycorn Limited
71-75 Shelton Street
London
WC2H 9JQ

Registered number of holder, for example company number, charity number (where applicable)

12705804

Name, address and telephone number of designated premises supervisor where the premises licence authorises for the supply of alcohol

Cornelius James Taylor-Ferreira

~~XXXXXXXXXX~~

~~XXXXXXXXXX~~

~~XXXXXXXXXX~~

Personal licence number and issuing authority of personal licence held by designated premises supervisor where the premises licence authorises for the supply of alcohol

Personal Licence Number: 20/02200/LIPERS
Licensing Authority: London Borough Of Croydon

A1

Date Original Licence Granted: 14.08.2020

Date This Licence Valid From: 14.08.2020

**Licensing Manager
Place Department**

Annex 1 – Mandatory conditions

1. The supply of alcohol

Condition A1.

No supply of Alcohol may be made under the Premises Licence:

- (a) At a time when there is no Designated Premises Supervisor in respect of the Premises Licence; or
- (b) At a time when the Designated Premises Supervisor does not hold a Personal Licence is suspended.

Condition A2

Every supply of alcohol under the Premises Licence must be made, or authorised by a person who holds a Personal Licence.

Condition A3

- (1) The responsible person must ensure that staff on relevant premises do not carry out, arrange or participate in any irresponsible promotions in relation to the premises.
- (2) In this paragraph, an irresponsible promotion means any one or more of the following activities, or substantially similar activities, carried on for the purpose of encouraging the sale or supply of alcohol for consumption on the premises—
 - (a) games or other activities which require or encourage, or are designed to require or encourage, individuals to—
 - (i) drink a quantity of alcohol within a time limit (other than to drink alcohol sold or supplied on the premises before the cessation of the period in which the responsible person is authorised to sell or supply alcohol), or
 - (ii) drink as much alcohol as possible (whether within a time limit or otherwise)
 - (b) provision of unlimited or unspecified quantities of alcohol free or for a fixed or discounted fee to the public or to a group defined by a particular characteristic in a manner which carries a significant risk of undermining a licensing objective;
 - (c) provision of free or discounted alcohol or any other thing as a prize to encourage or reward the purchase and consumption of alcohol over a period of 24 hours or less in a manner which carries a significant risk of undermining a licensing objective;
 - (d) selling or supplying alcohol in association with promotional posters or flyers on, or in the vicinity of, the premises which can reasonably be considered to condone, encourage or glamorise anti-social behaviour or to refer to the effects of drunkenness in any favourable manner;
 - (e) dispensing alcohol directly by one person into the mouth of another (other than where that other person is unable to drink without assistance by reason of disability).

Condition A4

The responsible person must ensure that free potable water is provided on request to customers where it is reasonably available.

Condition A5

- (1) The premises licence holder or club premises certificate holder must ensure that an age verification policy is adopted in respect of the premises in relation to the sale or supply of alcohol.
- (2) The designated premises supervisor in relation to the premises licence must ensure that the supply of alcohol at the premises is carried on in accordance with the age verification policy.

- (3) The policy must require individuals who appear to the responsible person to be under 18 years of age (or such older age as may be specified in the policy) to produce on request, before being served alcohol, identification bearing their photograph, date of birth and either—
- (a) a holographic mark, or
 - (b) an ultraviolet feature.

Condition A6

The responsible person must ensure that—

- (a) where any of the following alcoholic drinks is sold or supplied for consumption on the premises (other than alcoholic drinks sold or supplied having been made up in advance ready for sale or supply in a securely closed container) it is available to customers in the following measures—
 - (i) beer or cider: ½ pint;
 - (ii) gin, rum, vodka or whisky: 25 ml or 35 ml; and
 - (iii) still wine in a glass: 125 ml;
- (b) these measures are displayed in a menu, price list or other printed material which is available to customers on the premises; and
- (c) where a customer does not in relation to a sale of alcohol specify the quantity of alcohol to be sold, the customer is made aware that these measures are available.

Additional Mandatory Licensing Conditions, Minimum Drinks Pricing:

1. A relevant person shall ensure that no alcohol is sold or supplied for consumption on or off the premises for a price which is less than the permitted price.
2. For the purposes of the condition set out in paragraph 1
 - (a) "duty" is to be construed in accordance with the Alcoholic Liquor Duties Act 1979
 - (b) "permitted" price is the price found by applying the formula - $P=D+(D \times V)$ where:
 - (i) P is the permitted price,
 - (ii) D is the amount of duty chargeable in relation to the alcohol as if the duty were charged on the date of the sale or supply of the alcohol, and
 - (iii) V is the rate of value added tax chargeable in relation to the alcohol as if the value added tax were charged on the date of the sale or supply of the alcohol;
 - (c) "relevant person" means, in relation to premises in respect of which there is in force a premises licence
 - (i) the holder of the premises licence,
 - (ii) the designated premises supervisor (if any) in respect of such a licence, or
 - (iii) the personal licence holder who makes or authorises a supply of alcohol under such a licence;
 - (d) "relevant person" means, in relation to premises in respect of which there is in force a club premises certificate, any member or officer of the club present on the premises in a capacity which enables the member or officer to prevent the supply in question; and
 - (e) "value added tax" means value added tax charged in accordance with the Value Added Tax Act 1994.
3. Where the permitted price given by Paragraph (b) of paragraph 2 would (apart from this paragraph) not be a whole number of pennies, the price given by that sub-paragraph shall be taken to be the price actually given by that sub-paragraph rounded up to the nearest penny.

4. (1) Sub-paragraph (2) applies where the permitted price given by Paragraph (b) of paragraph 2 on a day ("the first day") would be different from the permitted price on the next day ("the second day") as a result of a change to the rate of duty or value added tax.
- (2) The permitted price which would apply on the first day applies to sales or supplies of alcohol which take place before the expiry of the period of 14 days beginning on the second day.

Annex 2 – Conditions consistent with the Operating Schedule

The Premises licence holder shall (ensure) that –

1. No alcohol will be exposed for sale before 1200 hours daily.
2. A CCTV system will be installed at the premises covering the entrance and all internal areas where alcohol is displayed. A head and shoulders image to identification standard shall be captured of every person entering the premises. Images shall be kept for 28 days and supplied to the police or local authority on request.
3. A member of staff trained in the use of the CCTV system must be available at the premises at all times in order to show officers or local authority recordings where needed. A takeaway copy provided on suitable digital media will be available within 48hrs if required.
4. The CCTV system will display, on screen and on any recording, the correct time and date that images were captured.
5. CCTV signage will be displayed, reminding customers that CCTV is in operation.
6. An incident log shall be kept at the premises and made available on request to the Police or an authorised officer of the London Borough of Croydon. The log will record the following:
 - Date of the incident
 - Time of the incident
 - Location of the incident
 - Persons concerned in the incident
 - Summary of incident
 - Identification of emergency personnel concerned where possible
 - All crimes reported to the venue
 - All ejections of customers or refusal of entry
 - Any incidents of disorder (disturbance caused by either one person or a group of people).
 - Any faults in the CCTV system or searching equipment or scanning equipment
7. A challenge 25 policy will be in operation at the premises with operate signage on display throughout the premises.
8. The premises will have a refusal book or electronic system to record all refusals of sales, this must be made available to the police and local authority officers upon reasonable request.
9. No Beer, Lager, Cider or Perry is stocked, exposed for sale or sold that exceeds 6% ABV with the exception of genuine premium craft/artisan products.
10. Clear and legible notices shall be prominently displayed at the exit to remind customers to leave quietly and have regard for the neighbours.

11. The licensable activities authorised by this licence and provided at the premises shall be ancillary to the main function of the garden shop.
12. Any CCTV breakdown or system failure will be notified to the Police and Local Authority immediately & remedied as soon as practicable. Repair records / invoices shall be kept on site for at least 12 months and be readily available to be viewed by all authorised persons upon request. All CCTV electrical and data storage equipment shall be connected via a surge protected extension lead/cable.
13. No alcohol shall be sold if the CCTV equipment is inoperative for any reason.
14. PASS training must be undertaken by anyone making a sale at the premises that does not have a personal licence. Training records must be kept at the premises at all times and made available to police and authorised council officers on request. Training must take place every 6 months.
15. No sale of alcohol shall be made unless the designated premises supervisor or personal licence holder is present in the licensed area of the premises.

Annex 3 – Conditions attached after a hearing by the licensing authority

N/A

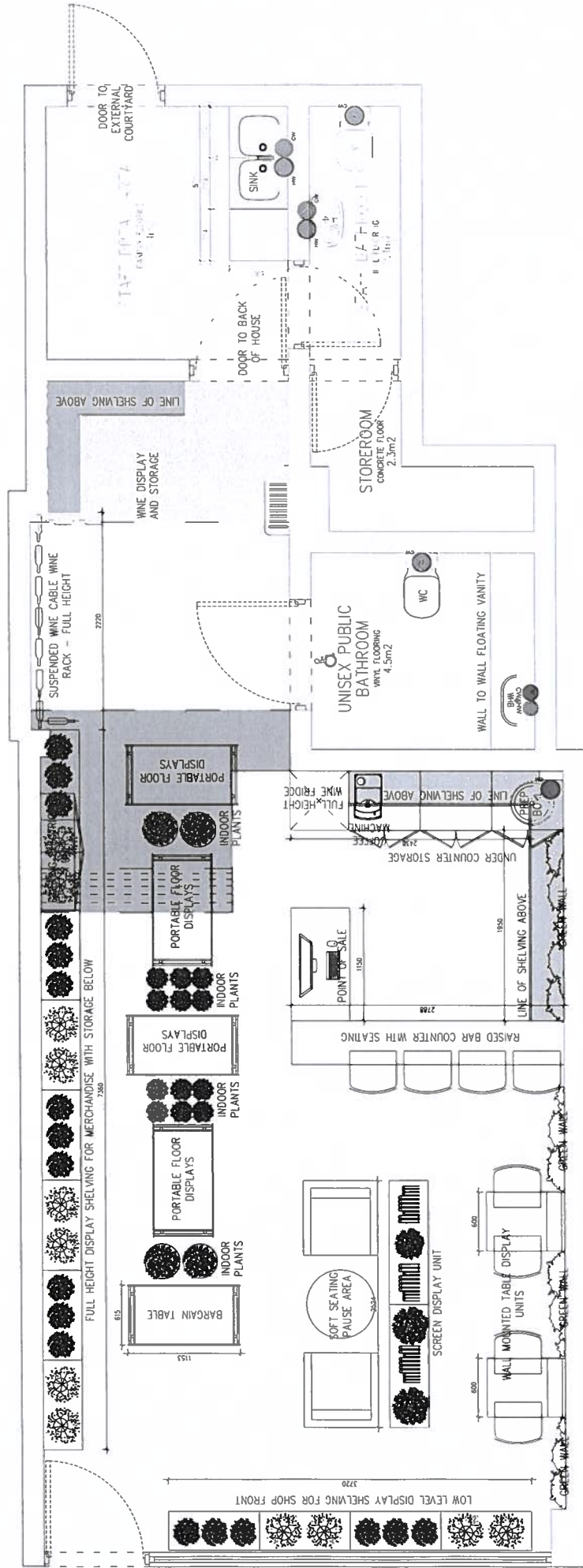

DESIGNER'S SIGNATURE
 PROJECT SIGNATURE
 CLIENT SIGNATURE

NOTES

1. The design of this drawing is the Copyright of the Designer.
2. This drawing is not to be scaled. Figured dimensions to be used. All dimensions are in millimeters unless otherwise stated.
3. This drawing must be read in conjunction with all relevant drawings and schedules.
4. Contractor and Sub-contractors to check all site dimensions and levels before being put in hand.
5. All work is to be done in accordance with the current Building Regulations.
6. All work is to be done in accordance with the current Building Regulations.
7. The Contractor must obtain the Designer's written confirmation of any variation to the contract before being put in hand.

REVISION	REV	DESCRIPTION
	001	ISSUED FOR INFORMATION

ORG No	SHGPA/2020/002
DRAWING NUMBER	SHGPA/2020/001
DATE	13.07.2020
DESCRIPTION	PROPOSED NEW FLOOR PLAN
SCALE	1:1

SHOP 6, THE PARADE
 258 COULSDON ROAD
 OLD COULSDON
 SURREY CR5 1EA
 LONDON

LT DEVELOPMENTS
 CONSULTING
 DESIGN
 MANAGEMENT

Application to vary a premises licence under the Licensing Act 2003

PLEASE READ THE FOLLOWING INSTRUCTIONS FIRST

Before completing this form please read the guidance notes at the end of the form. If you are completing this form by hand please write legibly in block capitals. In all cases ensure that your answers are inside the boxes and written in black ink. Use additional sheets if necessary.

You may wish to keep a copy of the completed form for your records.

I/We Aycorn Limited Trading as The Aycorn Shoppe

(Insert name(s) of applicant)

being the premises licence holder, apply to vary a premises licence under section 34 of the Licensing Act 2003 for the premises described in Part 1 below

Premises licence number 20/02035/LIPREM

Part 1 – Premises Details

Postal address of premises or, if none, ordnance survey map reference or description 258 Coulsdon Road Shop 6 The Parade Old Coulsdon			
Post town	Old Coulsdon	Postcode	CR51EH

Telephone number at premises (if any)	01737516425
Non-domestic rateable value of premises	£9100

Part 2 – Applicant details

Daytime contact telephone number	01737516425		
E-mail address (optional)	aycorn@aycorn.co.uk		
Current postal address if different from premises address	258 Coulsdon Road Old Coulsdon		
Post town	Coulsdon	Postcode	CR51EH

Part 3 - Variation

Please tick as appropriate

Do you want the proposed variation to have effect as soon as possible? Yes No

If not, from what date do you want the variation to take effect? DD MM YYYY

--	--	--	--	--	--	--	--

Do you want the proposed variation to have effect in relation to the introduction of the late night levy? (Please see guidance note 1) Yes No

Please describe briefly the nature of the proposed variation (Please see guidance note 2)

We would like to do a variation on our opening hours to be: 9:00 till 22:00
We would like to do a variation on our alcohol Licence to be : 12:00 – 22:00
We would like to submit our new layout for the premises as we changed it recently.
We would like to add recorder music during our opening hours
We would like to add live music to our operating schedule

Our current opening Hours is 8:00 till 21:00
Due to the nature of our business which is a café and plant/garden shop by day with a wine bar serving food from 12:00 we realised it will be better for us to change our service time to customers to support our business model.

If your proposed variation would mean that 5,000 or more people are expected to attend the premises at any one time, please state the number expected to attend:

Part 4 Operating Schedule

Please complete those parts of the Operating Schedule below which would be subject to change if this application to vary is successful.

- | Provision of regulated entertainment (Please see guidance note 3) | Please tick all that apply |
|---|-----------------------------------|
| a) plays (if ticking yes, fill in box A) | <input type="checkbox"/> |
| b) films (if ticking yes, fill in box B) | <input type="checkbox"/> |
| c) indoor sporting events (if ticking yes, fill in box C) | <input type="checkbox"/> |
| d) boxing or wrestling entertainment (if ticking yes, fill in box D) | <input type="checkbox"/> |
| e) live music (if ticking yes, fill in box E) | x
<input type="checkbox"/> |
| f) recorded music (if ticking yes, fill in box F) | x
<input type="checkbox"/> |
| g) performances of dance (if ticking yes, fill in box G) | <input type="checkbox"/> |
| h) anything of a similar description to that falling within (e), (f) or (g) (if ticking yes, fill in box H) | <input type="checkbox"/> |

Provision of late night refreshment (if ticking yes, fill in box I)

Supply of alcohol (if ticking yes, fill in box J) x

In all cases complete boxes K, L and M

E

Live music Standard days and timings (please read guidance note 8)			<u>Will the performance of live music take place indoors or outdoors or both – please tick (please read guidance note 4)</u>	Indoors	<input type="checkbox"/>
				Outdoors	<input type="checkbox"/>
				Both	<input type="checkbox"/>
Day	Start	Finish	<u>Please give further details here (please read guidance note 5)</u>		
Mon	18:00	22:00			
Tue	18:00	22:00	<u>State any seasonal variations for the performance of live music (please read guidance note 6)</u>		
Wed	18:00	22:00			
Thur	18:00	22:00	<u>Non standard timings. Where you intend to use the premises for the performance of live music at different times to those listed in the column on the left, please list (please read guidance note 7)</u>		
Fri	18:00	22:00			
Sat	12:00	22:00			
Sun					

F

Recorded music Standard days and timings (please read guidance note 8)			<u>Will the playing of recorded music take place indoors or outdoors or both – please tick</u> (please read guidance note 4)	Indoors	<input type="checkbox"/>
				Outdoors	<input type="checkbox"/>
				Both	<input type="checkbox"/>
Day	Start	Finish	<u>Please give further details here</u> (please read guidance note 5)		
Mon	9:00	23:00			
Tue	9:00	23:00	<u>State any seasonal variations for the playing of recorded music</u> (please read guidance note 6)		
Wed	9:00	23:00			
Thur	9:00	23:00	<u>Non standard timings. Where you intend to use the premises for the playing of recorded music at different times to those listed in the column on the left, please list</u> (please read guidance note 7)		
Fri	9:00	23:00			
Sat	9:00	23:00			
Sun	12:00	18:00			

J

Supply of alcohol Standard days and timings (please read guidance note 8)			Will the supply of alcohol be for consumption – please tick (please read guidance note 9)	On the premises	<input type="checkbox"/>
				Off the premises	<input type="checkbox"/>
				Both	<input checked="" type="checkbox"/>
Day	Start	Finish	<u>State any seasonal variations for the supply of alcohol</u> (please read guidance note 6)		
Mon	12:00	22:30			
Tue	12:00	22:30			
Wed	12:00	22:30			
Thur	12:00	22:30			
Fri	12:00	22:30			
Sat	12:00	22:30			
Sun	12:00	18:00			
			<u>Non-standard timings. Where you intend to use the premises for the supply of alcohol at different times to those listed in the column on the left, please list</u> (please read guidance note 7)		

K

Please highlight any adult entertainment or services, activities, other entertainment or matters ancillary to the use of the premises that may give rise to concern in respect of children (please read guidance note 10).

L

Hours premises are open to the public Standard days and timings (please read guidance note 8)			State any seasonal variations (please read guidance note 6)
Day	Start	Finish	
Mon	9:00	23:00	
Tue	9:00	23:00	
Wed	9:00	23:00	
Thur	9:00	23:00	
Fri	9:00	23:00	
Sat	9:00	23:00	
Sun	12:00	18:00	
			Non standard timings. Where you intend the premises to be open to the public at different times from those listed in the column on the left, please list (please read guidance note 7)

Please identify those conditions currently imposed on the licence which you believe could be removed as a consequence of the proposed variation you are seeking.

Change of opening hours
 Change of Alcohol Licence
 Addition of Live Music
 Change of Recorder Music

Please tick as appropriate

- I have enclosed the premises licence x
- I have enclosed the relevant part of the premises licence x

If you have not ticked one of these boxes, please fill in reasons for not including the licence or part of it below

Reasons why I have not enclosed the premises licence or relevant part of premises licence.

M Describe any additional steps you intend to take to promote the four licensing objectives as a result of the proposed variation:

a) General – all four licensing objectives (b, c, d and e) (please read guidance note 11)

We Propose to keep our premises safe at all times to the public by avoiding crime and disorder. We have all the appropriate signs on our premise to avoid selling alcohol to under age people. We ask for proof of ID when applicable. We keep the music as back ground music to minimise noise to our neighbours. We have CCTV all around our premises for public safety as well as fire and smoke alarm systems. We have signs where there is steps. We clean and disinfect our premises daily. We ask our guests to be mindful of the neighbours when leaving the premises. We do not allow children during our evening service of alcohol.

b) The prevention of crime and disorder

We Propose to keep our premises safe at all times to the public by avoiding crime and disorder. We have all the appropriate signs on our premise to avoid selling alcohol to under age people.

c) Public safety

We have all the appropriate signs on our premise to avoid selling alcohol to under age people. We have CCTV all around our premises for public safety as well as fire and smoke alarm systems. We have signs where there is steps. We clean and disinfect our premises daily

d) The prevention of public nuisance

We ask our guests to be mindful of the neighbours when leaving the premises.
We keep the music as back ground music to minimise noise to our neighbours.

e) The protection of children from harm

We do not allow children during our evening service of alcohol.

Checklist:

Please tick to indicate agreement

- I have made or enclosed payment of the fee; or x
- I have not made or enclosed payment of the fee because this application has been made in relation to the introduction of the late night levy.
- I have sent copies of this application and the plan to responsible authorities and others where applicable. x
- I understand that I must now advertise my application. x
- I have enclosed the premises licence or relevant part of it or explanation. x
- I understand that if I do not comply with the above requirements my application will be rejected. x

IT IS AN OFFENCE, UNDER SECTION 158 OF THE LICENSING ACT 2003, TO MAKE A FALSE STATEMENT IN OR IN CONNECTION WITH THIS APPLICATION. THOSE WHO MAKE A FALSE STATEMENT MAY BE LIABLE ON SUMMARY CONVICTION TO A FINE OF ANY AMOUNT.



Part 5 – Signatures (please read guidance note 12)

Signature of applicant (the current premises licence holder) or applicant’s solicitor or other duly authorised agent (please read guidance note 13). **If signing on behalf of the applicant, please state in what capacity.**

Signature	Mr Cornelius James Taylor-Ferreira 
Date	15/06/2022
Capacity	Director

Where the premises licence is jointly held, signature of 2nd applicant (the current premises licence holder) or 2nd applicant’s solicitor or other authorised agent (please read guidance note 14). **If signing on behalf of the applicant, please state in what capacity.**

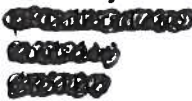
Signature	
Date	
Capacity	

Contact name (where not previously given) and address for correspondence associated with this application (please read guidance note 15)			
Jamie Taylor Ferreira			
			
Post town	Coulsdon	Post code	
Telephone number (if any)			
If you would prefer us to correspond with you by e-mail, your e-mail address (optional)			

Notes for Guidance

This application cannot be used to vary the licence so as to extend the period for which the licence has effect or to vary substantially the premises to which it relates. If you wish to make that type of change to the premises licence, you should make a new premises licence application under section 17 of the Licensing Act 2003.

1. You do not have to pay a fee if the only purpose of the variation for which you are applying is to avoid becoming liable for the late night levy
2. Describe the premises. For example, the type of premises, its general situation and layout and any other information which could be relevant to the licensing objectives. Where your application includes off-supplies of alcohol and you intend to provide a place of consumption of these off-supplies of alcohol, you must include a description of where the place will be and its proximity to the premises.
3. In terms of specific regulated entertainments please note that:
 - Plays: no licence is required for performances between 08.00 and 23.00 on any day, provided that the audience does not exceed 500.
 - Films: no licence is required for 'not-for-profit' film exhibition held in community premises between 08.00 and 23.00 on any day provided that the audience does not exceed 500 and the organiser (a) gets consent to the screening from a person who is responsible for the premises; and (b) ensures that each such screening abides by age classification ratings.
 - Indoor sporting events: no licence is required for performances between 08.00 and 23.00 on any day, provided that the audience does not exceed 1000.
 - Boxing or Wrestling Entertainment: no licence is required for a contest, exhibition or display of Greco-Roman wrestling, or freestyle wrestling between 08.00 and 23.00 on any day, provided that the audience does not exceed 1000. Combined fighting sports – defined as a contest, exhibition or display which combines boxing or wrestling with one or more martial arts – are licensable as a boxing or wrestling entertainment rather than an indoor sporting event.
 - Live music: no licence permission is required for:
 - a performance of unamplified live music between 08.00 and 23.00 on any day, on any premises.
 - a performance of amplified live music between 08.00 and 23.00 on any day on premises authorised to sell alcohol for consumption on those premises, provided that the audience does not exceed 500.
 - a performance of amplified live music between 08.00 and 23.00 on any day, in a workplace that is not licensed to sell alcohol on those premises, provided that the audience does not exceed 500.
 - a performance of amplified live music between 08.00 and 23.00 on any day, in a church hall, village hall, community hall, or other similar community premises, that is not licensed by a premises licence to sell alcohol, provided that (a) the audience does not exceed 500, and (b) the organiser gets consent for the performance from a person who is responsible for the premises.
 - a performance of amplified live music between 08.00 and 23.00 on any day, at the non-residential premises of (i) a local authority, or (ii) a school, or (iii) a hospital, provided that (a) the audience does not exceed 500, and (b) the organiser gets consent for the performance on the relevant premises from: (i) the local authority concerned, or (ii) the school or (iii) the health care provider for the hospital.
 - Recorded Music: no licence permission is required for:

- any playing of recorded music between 08.00 and 23.00 on any day on premises authorised to sell alcohol for consumption on those premises, provided that the audience does not exceed 500.
 - any playing of recorded music between 08.00 and 23.00 on any day, in a church hall, village hall, community hall, or other similar community premises, that is not licensed by a premises licence to sell alcohol, provided that (a) the audience does not exceed 500, and (b) the organiser gets consent for the performance from a person who is responsible for the premises.
 - any playing of recorded music between 08.00 and 23.00 on any day, at the non-residential premises of (i) a local authority, or (ii) a school, or (iii) a hospital, provided that (a) the audience does not exceed 500, and (b) the organiser gets consent for the performance on the relevant premises from: (i) the local authority concerned, or (ii) the school proprietor or (iii) the health care provider for the hospital.
- Dance: no licence is required for performances between 08.00 and 23.00 on any day, provided that the audience does not exceed 500. However, a performance which amounts to adult entertainment remains licensable.
 - Cross activity exemptions: no licence is required between 08.00 and 23.00 on any day, with no limit on audience size for:
 - any entertainment taking place on the premises of the local authority where the entertainment is provided by or on behalf of the local authority;
 - any entertainment taking place on the hospital premises of the health care provider where the entertainment is provided by or on behalf of the health care provider;
 - any entertainment taking place on the premises of the school where the entertainment is provided by or on behalf of the school proprietor; and
 - any entertainment (excluding films and a boxing or wrestling entertainment) taking place at a travelling circus, provided that (a) it takes place within a moveable structure that accommodates the audience, and (b) that the travelling circus has not been located on the same site for more than 28 consecutive days.
4. Where taking place in a building or other structure please tick as appropriate (indoors may include a tent).
 5. For example state type of activity to be authorised, if not already stated, and give relevant further details, for example (but not exclusively) whether or not music will be amplified or unamplified.
 6. For example (but not exclusively), where the activity will occur on additional days during the summer months.
 7. For example (but not exclusively), where you wish the activity to go on longer on a particular day e.g. Christmas Eve.
 8. Please give timings in 24 hour clock (e.g. 16.00) and only give details for the days of the week when you intend the premises to be used for the activity.
 9. If you wish people to be able to consume alcohol on the premises, please tick 'on the premises'. If you wish people to be able to purchase alcohol to consume away from the premises, please tick 'off the premises'. If you wish people to be able to do both, please tick 'both'.
 10. Please give information about anything intended to occur at the premises or ancillary to the use of the premises which may give rise to concern in respect of children regardless of whether you intend children to have access to the premises, for example (but not exclusively) nudity or semi-nudity, films for restricted age groups or the presence of gaming machines.
 11. Please list here steps you will take to promote all four licensing objectives together.
 12. The application form must be signed.

13. An applicant's agent (for example solicitor) may sign the form on their behalf provided that they have actual authority to do so.
14. Where there is more than one applicant, each of the applicants or their respective agents must sign the application form.
15. This is the address which we shall use to correspond with you about this application.

The Aycorn Shoppe Table Plan



Table 1 is for 2 or 3 people

Table 2 is for 2 or 3 people

Table 3 and 4 can be split for two people but put together for 4, 5 or 6 people

Table 5 is for 2, 3 or 4 people

Please note table 1, 2, 3, 4 and 5 can be put together for a party of 10 - 12 people

Table 6 is for 2 people

Table 7 and 8 can be split for two people each or put together for 4, 5 or 6 people

Table 9 is for 2 people

Table 10 is for 2 people

The bar can sit 4 people (2 x parties of 2)

Table 11 can be for 2 or 3 people

The Naughty corner is for 4 or 5 people

Table 12 is for 4 or 5 people

Table 13 is for 4 or 5 people

LONDON BOROUGH OF CROYDON

Licensing Act 2003

REPRESENTATION FORM

The boxes marked * are mandatory, and any forms with these incompletes will be automatically refused

*Your Name	[REDACTED]
*Postal and email address	[REDACTED] Old Coulsdon [REDACTED]
Contact telephone number	

*Name of the premises you are making a representation about	The Aycorn Shoppe
*Address of the premises you are making a representation about	6 The Parade 258 Coulsdon Road Old Coulsdon CR5 1EH but it should be CR5 1EA

*Which of the four licensing Objectives does your representation relate to?	<i>Please detail the evidence supporting your representation. Or the reason for your representation, use separate sheets if necessary</i>
General	<p>I live directly [REDACTED] the shop but was not made aware of these proposals by the applicant before they were submitted. I only learnt of them from a neighbour.</p> <p>Aycorn have also made a separate Planning Application to vary their opening hours. This form cannot be found online on the Council Planning Register as they have put the incorrect postcode on that application. It is however listed under CR5 1EA. They say that a new layout for the premises was submitted but this cannot be found anywhere.</p> <p>No personal details of the Applicant have been provided on their form. Who is their Designated Premises Supervisor, and do they hold a Personal Licence?</p>

<p>To prevent crime and disorder</p>	<p>Aycorn say they have CCTV 'all around their premises'. There are no CCTV cameras externally that I can see.</p> <p>Anti-social behaviour: on the occasion when they had a late licence, the people leaving the premises at 11pm were making considerably more noise than those leaving under the current licence time of 9pm. The talking, shouting, swearing, waiting for taxis went on for about 30 minutes after closing time.</p> <p>Opening Hours: There are several conflicting and confusing times between the two applications</p> <p>Opening time Mon – Sat: Planning App p3 says 0800. This app p2 & p14 say 0900?</p> <p>Closing time Mon – Sat Planning App p3 says 2300. This App p2 says 2200 and on p14 says 2300?</p> <p>Alcohol Hours. This App has closing time of 2200 on p2 and on p13 it says 2230?</p>
<p>Public safety</p>	<p>The total seating capacity of the premises has been significantly increased from the 10 seats inside the shop as on their original 2020 application. I counted:</p> <ul style="list-style-type: none"> - 20 seats internally (they seem to have removed the staff break area and the staff bathroom). - 8 seats on the front external raised platform and 8 seats in what was their external yard area. This area is now under a plastic sheeted roof. - The total number of seats is now 36. They have only one unisex toilet. Regulations for cafes say one toilet is only adequate for not more than 16 seats.
<p>To prevent public nuisance</p>	<p>This is an old 1930's building without any soundproofing between the floors that is appropriate for recorded music or live music being played all day and into the night.</p>

	<p>Music (recorded) is often heard in the evenings in my kitchen, living room and in my daughter's bedroom, all directly above the shop. I have asked them many times to turn down the volume. On an occasion when they had a late licence until 11, they didn't inform me and I had to go out at 10:50pm as the music was intolerably loud.</p> <p>Live music on Wednesday evenings has caused more problems. I have had to ask them to turn the volume down on several occasions when I can't comfortably hear my TV and when my daughter has struggled to get to sleep (she is still in full time education).</p> <p>People sitting in their new outside area to the rear can be heard from my son's bedroom and from my terrace.</p>
<p>To protect children from harm</p>	<p>To be reviewed if under aged people are seen in the premises.</p>

I/We fully understand that this Representation will be made available to the applicant and included in the Sub Committee's Hearing papers which are publicly accessible documents, and any subsequent appeal court proceedings.



Signed:

Date: 14 / 7/ 2022

This form must be returned within the Statutory Period, which ends on:- 15th July 2022
If this form is sent as an email attachment, its transmission will imply that you have agreed the above conditions.
Please see Notes overleaf.

13/7/22

A3

LONDON BOROUGH OF CROYDON

Licensing Representation Form August 2012

Licensing Act 2003

REPRESENTATION FORM

The boxes marked * are mandatory, and any forms with these incompletes will be automatically refused

*Your Name	XXXXXXXXXXXX
*Postal and email address	XXXXXXXXXXXX OLD COULSDON XXXXXX (W)
Contact telephone number	

*Name of the premises you are making a representation about	The Aycorn Shoppe
*Address of the premises you are making a representation about	258 Coulsdon Road Shop 6 The Parade Old Coulsdon CR5 1EH

*Which of the four licensing Objectives does your representation relate to?	Please detail the evidence supporting your representation. Or the reason for your representation, use separate sheets if necessary
General	Not the right location for live music or bar -
To prevent crime and disorder	Increase number of people on the parade at night in alley behind → crime wife, burglary etc. No CCTV
Public safety	
To prevent public nuisance	Noise pollution.
To protect children from harm	

I/We fully understand that this Representation will be made available to the applicant and included in the Sub Committee's Hearing papers which are publicly accessible documents, and any subsequent appeal court proceedings.

Signed: 

Date: 9/7/22

This form must be returned within the Statutory Period, which ends on:- 15th July 2022

A3

**LONDON BOROUGH
OF CROYDON**

Licensing Representation Form August 2012

Licensing Act 2003

REPRESENTATION FORM

The boxes marked * are mandatory, and any forms with these incompletes will be automatically refused

*Your Name	XXXXXXXXXX
*Postal and email address	102 Bourneville Road Croydon Surrey
Contact telephone number	

*Name of the premises you are making a representation about	The Aycorn Shoppe
*Address of the premises you are making a representation about	258 Coulsdon Road Shop 6 The Parade Old Coulsdon CR5 1EH but it should be CR5 1EA

*To which of the four licensing Objectives does your representation relate.	Please detail the evidence supporting your representation. Or the reason for your representation, use separate sheets if necessary
General	<p>My daughter Corals is the Leaseholder of 258 The Parade, the 4th floor above the shop Acorn's shop. She was not made aware of these proposals by the applicant, and I am making this representation as I am very much aware of the current problematic situation which is causing her anxiety.</p> <p>From 2016 until 2020 she never had any issues with the previous leaseholder, Corals.</p> <p>Aycorn's application has not been displayed correctly on a blue coloured form, nor displayed in a prominently visible position. They say that a new layout for the premises was submitted with their application but no trace of this can be found online. It is also complicated by the fact that they have used the wrong postcode for the application. It should be CR5 1EA.</p> <p>They have also not provided details of the Name, Address, or contact details of the Applicant on their application form.</p>
To prevent crime and disorder	<p>Aycorn's application twice mentions having CCTV <u>all around the premises</u>. This is incorrect. There are no CCTV cameras externally.</p> <p>Recently, when they had a late licence, without informing anyone, the people leaving the premises at 11pm were making considerably more noise than those leaving under the current shop closure time of 9pm. The talking, shouting, swearing, waiting for taxis went on for about 30 minutes after closing time. As all the shops in the parade have residential units above, this disturbance late at night is neither wanted nor appropriate, as the area is within the Bradmore Green Conservation Area.</p> <p>Already it has been noted that on many, many occasions the shop has still been open well after the 9pm watershed for closing. It is understood that the police have twice raided the shop after their closing time.</p>

	<p>There are several conflicting times given between this application (ref App B) and their separate application to vary their opening hours of their planning application, ref No 22/02622/CONR (ref App A). These all need correcting to agree with each other. For example:</p> <p>Opening time Mon – Sat: Planning App A says 0800. This App B p2 & p14 say 0900?</p> <p>Closing time Mon – Sat Planning App A p3 says 2300. This App B p2 says 2200?</p> <p>Alcohol Hours. This App B has closing time of 2200 on p2 and on p13 it says 2230?</p>
<p>Public safety</p>	<p>The original approved shop layout showed only 10 seats on their premises. There are now just short of a <u>total of 40 seats at tables on the premises</u>. This includes 8 seats at tables in what was simply their rear external yard area (now under a most unsightly temporary blue plastic sheeted roof). In the shop they have removed both the original Staff Break Area and the Staff Bathroom at the rear of the shop to make way for more customer seating. So now they still only have the one original unisex toilet. I am sure having just one toilet does not comply with current regulations of seating v toilet provision.</p>
<p>To prevent public nuisance</p>	<p>This 1930's parade of shops does not have adequate soundproofing between the floors that would prevent the sound transmission of either recorded or live music from the shop without disturbance to the flat flat. living room living room and both her children's bedrooms are on the level directly above the shop. Her youngest child is still in full time education and has complained several times of not being able to get to sleep because of noise from the shop later in the evenings. In these summer months, with windows in her flat being open, she is also being disturbed by noise from both their front and rear external areas, as well as directly into her flat through the shop itself.</p> <p>My daughter has recently seen people urinating at the top of the alleyway. These people may not have come from Aycorn's shop, but it could be a reflection on their inadequate toilet provision.</p> <p>Music (recorded) is often heard in the evenings in the flat and she has had to ask them to turn down the volume. When they had a late licence, she had to go down at 10:50pm as the music was intolerably loud. <u>Live music</u> on Wednesday evenings has caused many more problems. Again, on occasions she has had to ask them to turn volumes down because she can't hear her TV and her daughter couldn't get to sleep. People sitting in their new outside area to the rear could be easily heard from her son's bedroom and from her rear patio terrace.</p> <p>As Aycorn have demonstrated that they cannot comply with their current closing time of 9pm, I strongly object to this application to extend their closing time to 11pm and am totally against the application for LIVE music to be played.</p> <p>I sincerely hope that, after your careful consideration, you will not approve this application</p>
<p>To protect children from harm</p>	<p>To be reviewed if under aged people are seen in the premises.</p>

I/We fully understand that this Representation will be made available to the applicant and included in the Sub Committee's Hearing papers which are publicly accessible documents, and any subsequent appeal court proceedings.

Signed:



Date: 11th July 2022

**LONDON BOROUGH
OF CROYDON**

Licensing Act 2003

REPRESENTATION FORM

The boxes marked * are mandatory, and any forms with these incompletes will be automatically refused

*Your Name	XXXXXXXXXX
*Postal and email address	XXXXXXXXXX , Old Coulsdon, XXXXXX
Contact telephone number	

*Name of the premises you are making a representation about	The Aycorn Shoppe
*Address of the premises you are making a representation about	258 Coulsdon Road Shop 6 The Parade Old Coulsdon CR5 1EH

*Which of the four licensing Objectives does your representation relate to?	Please detail the evidence supporting your representation. Or the reason for your representation, use separate sheets if necessary
General	
To prevent crime and disorder	I am a local resident and I'm concerned that the increase in alcohol licence and extended opening hours may result in disorderly behaviour later in the evening. This is a quiet, residential area and there may be an increase in the noise level once people leave the premises. This may also potentially increase the litter around the row of shops.
Public safety	The seating plan was 10 on the original plan in 2020, but they are proposing to increase this to 36, using the front and back of the shop. This seems like a large increase for such a small premises.
To prevent public nuisance	There is the potential for live music until 10pm. I do not feel that enough consideration has been taken for the residents of The Parade. They are 1930s buildings, which provide minimal sound insulation between floors. Although this does not personally impact me from where I live, I do not feel that it is acceptable for the significant impact which this will have on those residents, and others in the local vicinity. Although there is a pub (The Tudor Rose) nearby, they do not play live music and it appears that noise level is contained within that building, having little impact on neighbouring properties.
To protect children from harm	

I/We fully understand that this Representation will be made available to the applicant and included in the Sub Committee's Hearing papers which are publicly accessible documents, and any subsequent appeal court proceedings.

A3

Signed: 

Date: 10/7/22

This form must be returned within the Statutory Period, which ends on:- 15th July 2022

If this form is sent as an email attachment, its transmission will imply that you have agreed the above conditions.

Please see Notes overleaf.

Licensing Representation Form August 2012

NOTES

- 1) Please complete the form in black ink or type only.
- 2) If you do make a representation, which is considered relevant, you will be expected to attend a meeting of the Licensing Authority's Committee and any subsequent appeal proceedings in the Courts. If you don't attend the meeting for any reason the Committee will consider any representations that you have made.
- 3) All representations whether made on this form or not must be returned to this office within the statutory period, starting the day after the application was given to this Authority. The statutory period is 28 days for a full variation or 10 working days for a minor variation.
- 4) The representation must relate to one of more of the four licensing objectives, nothing else can be taken into account. The objectives are:
 1. **The prevention of crime and disorder.** This relates to any crime, disorder or anti-social behaviour at the premises or related to the management of the premises. The licence holder/applicant can't generally be held responsible for the conduct of individuals once they leave the premises;
 2. **Public safety.** This relates to the safety of the public on the premises, i.e. fire safety, electrical circuits, lighting, building safety and capacity, first aid etc.
 3. **Prevention of public nuisance.** This can relate to issues such as, hours of operation, noise emanating from the premises, vibrations, lighting, litter etc.
 4. **Protection of children from harm.** This relates to protecting children from the activities carried out on the premises whilst they are there. The law already provides special protections for children under 18 to buy alcohol.
- 5) Your representation will be passed to the applicant to allow them the opportunity to address your concerns. It will also be published in the report made available to the Licensing Sub-Committee, which will be publicly available. And if any subsequent appeal is made by any party, your representation will be used in the appeal court proceedings. Names and addresses will only be withheld from the Committee report at your request and with our agreement.
- 6) Note that it is **not** acceptable to lobby a councillor who is a member of the Licensing Committee.
- 7) Please return this form when completed with any continuation sheets, either by post or hand to:

London Borough of Croydon Place Department
Licensing Team, 6th Floor
Bernard Weatherill House
8 Mint Walk
Croydon CR0 1EA

THE GRANGE, CANONS HILL, OLD COULSDON CR5 1HB

11th July 2022

Further to my Representation Form attached...I would like to point out, as a member of the local Police community liaison panel, that this application would add to the burden of work for the Croydon police which is overstretched as it is

We cannot expect our police to be able to operate properly, in these difficult times, if there is a policy of turning a small flower shop(on a short and very narrow parade of 30s buildings with private residences above and a warden assisted block of flats adjacent), into a late hours music venue.

It would become a night club, and the whole area would be a hub for anti social activity, overcrowding and noise. The detrimental effect on the mental health of those living nearby and the lack of protection for residents would be disastrous.

A4

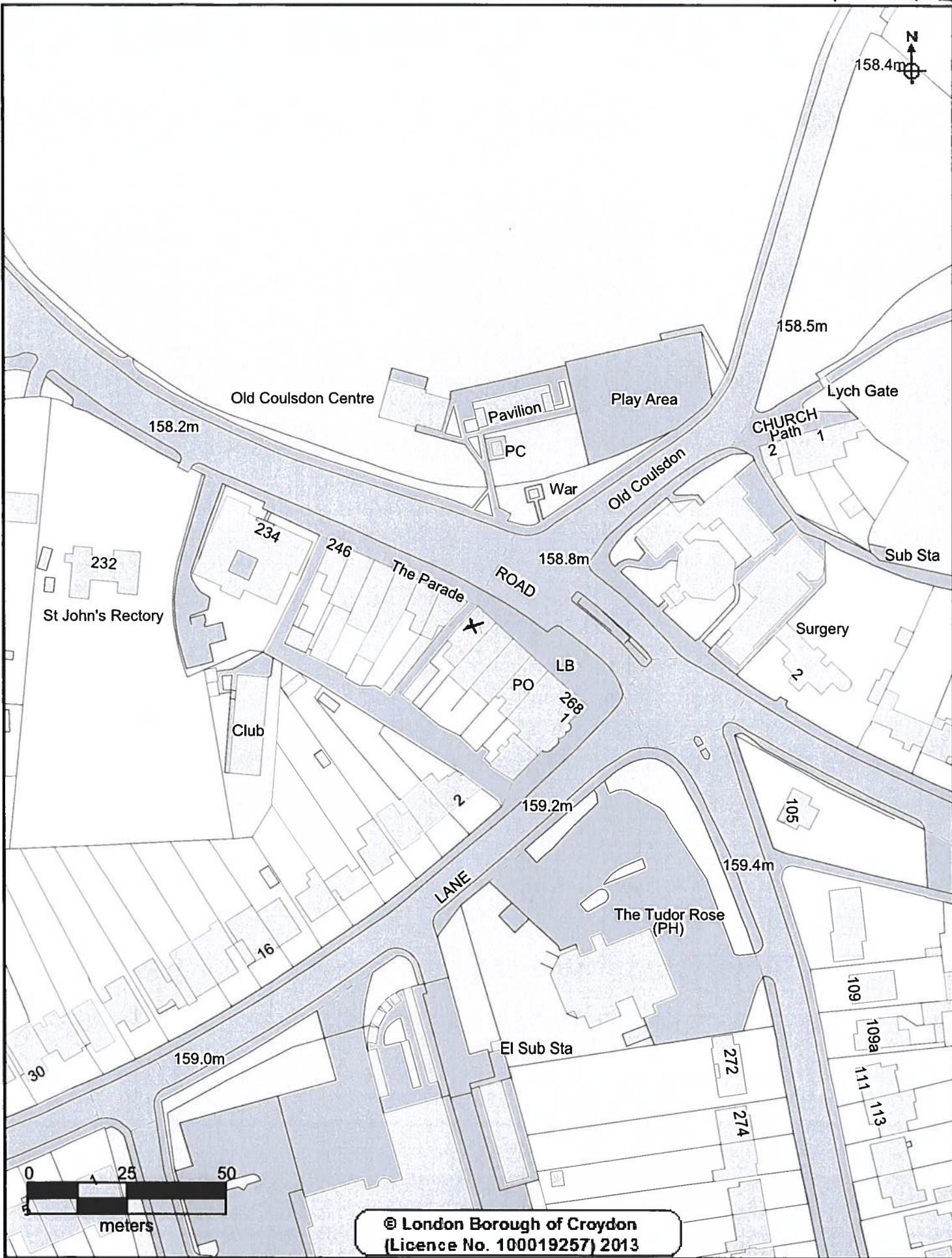

CROYDON
www.croydon.gov.uk

Crown Copyright Ordnance Survey (License No: 100019257) 2011

London Borough Croydon

X = 6 THE PARADE
 09-Aug-2022

Scale 1:1250

